

DIMENSIONS:

MECHLIFT 150

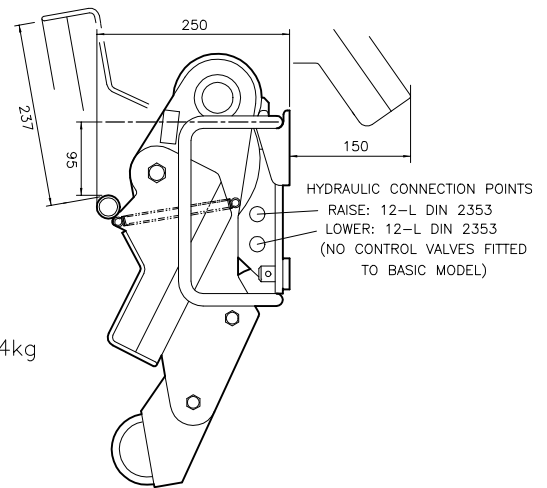
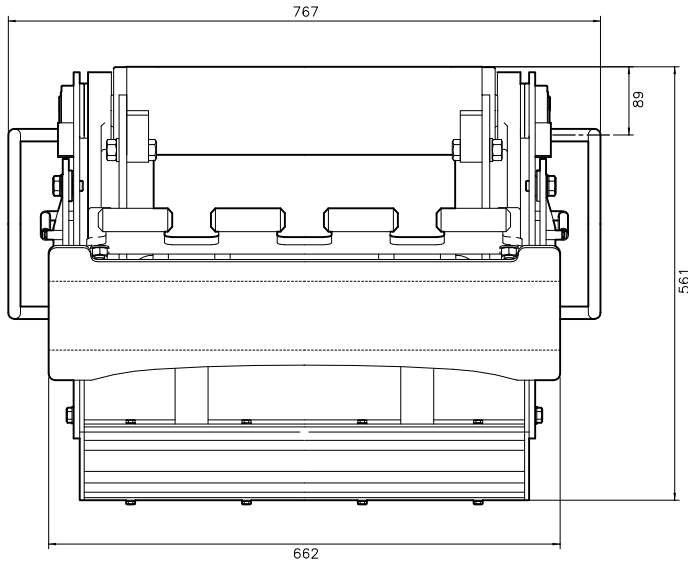

MASS: 84kg

INSTALLATION DIMENSIONS:

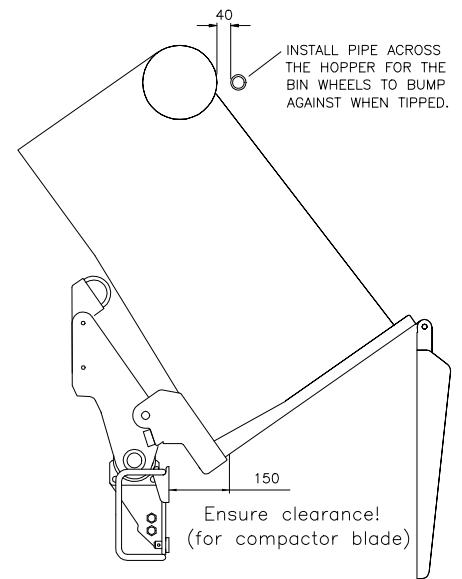
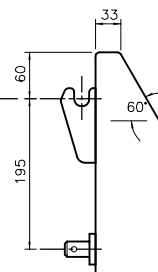
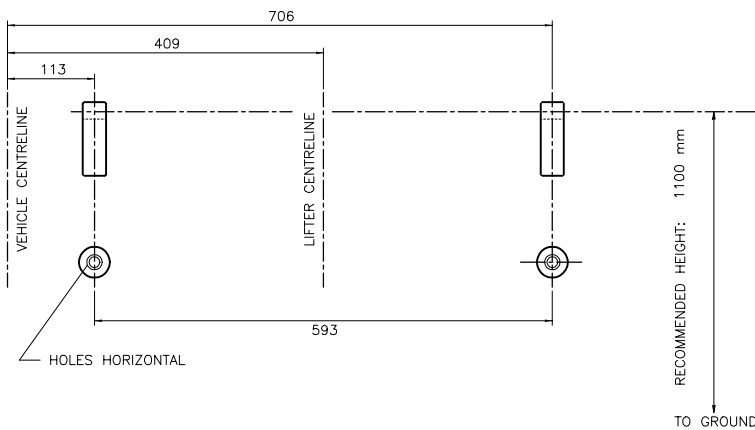

SPECIFICATIONS:

BIN TYPE:	1 X 240 litre per lifter
CYCLE TIME:	6 – 7 seconds
TIPPING ANGLE:	45 degrees
LIFTING CAPACITY:	1.7 kg per 1 bar pressure. (typical bin mass is 100 – 150 kg)
HYDRAULIC PRESSURE:	60 – 90 bar (for 100 – 150 kg) 150 bar maximum allowed
HYDRAULIC FLOW:	9 l/min (for 7 second cycle time) More than 11 l/min will damage the bins and/or the lifter.

OPTIONS:

Hydraulic installation kits to suit your vehicle's existing systems.

Additional hooks and studs for welding onto other vehicles.

Adapted for other styles of bin if required.

PATENTS:

SA Patent application 94/2290 pending. Other international applications also intended.

FEATURES:

- In comparison to other known "low-level" lifters, the Mechlift 150 is unique in that:
- it has 200 mm more ground clearance in its lowest position which allows the vehicle to be conveniently driven to the next pick-up point without first raising the empty lifter.
 - the "flip-down" bin edge clamp gives the least obstructed hopper edge while hand loading loose plastic bags. There are also no protruding parts which may snag bags and cause spillages.
 - the fact that the lifter is quickly and easily removable or transferable allows for the widest utilisation of your vehicles.